

[illegible]

Figure 10 shows two cross-sectional diagrams of a staircase, illustrating the calculation of the horizontal projection (Sloz) and vertical rise (Wzrost) for a flight with 10 steps. The top diagram shows a flight with a total horizontal projection of 180 cm and a total vertical rise of 120 cm. The bottom diagram shows a flight with a total horizontal projection of 180 cm and a total vertical rise of 144 cm. Both diagrams include a dashed line indicating the 'Dobrychod na zrazku' (good catch) and a dimension of 1.00 cm for the nosing.



Opis:	Budowa budynku sportowo-treningowego.	433
-------	---------------------------------------	-----

budynku zaplecza sanitarnego oraz przekrycia boisk zewnętrznych wraz z zagospodarowaniem terenu i infrastruktura


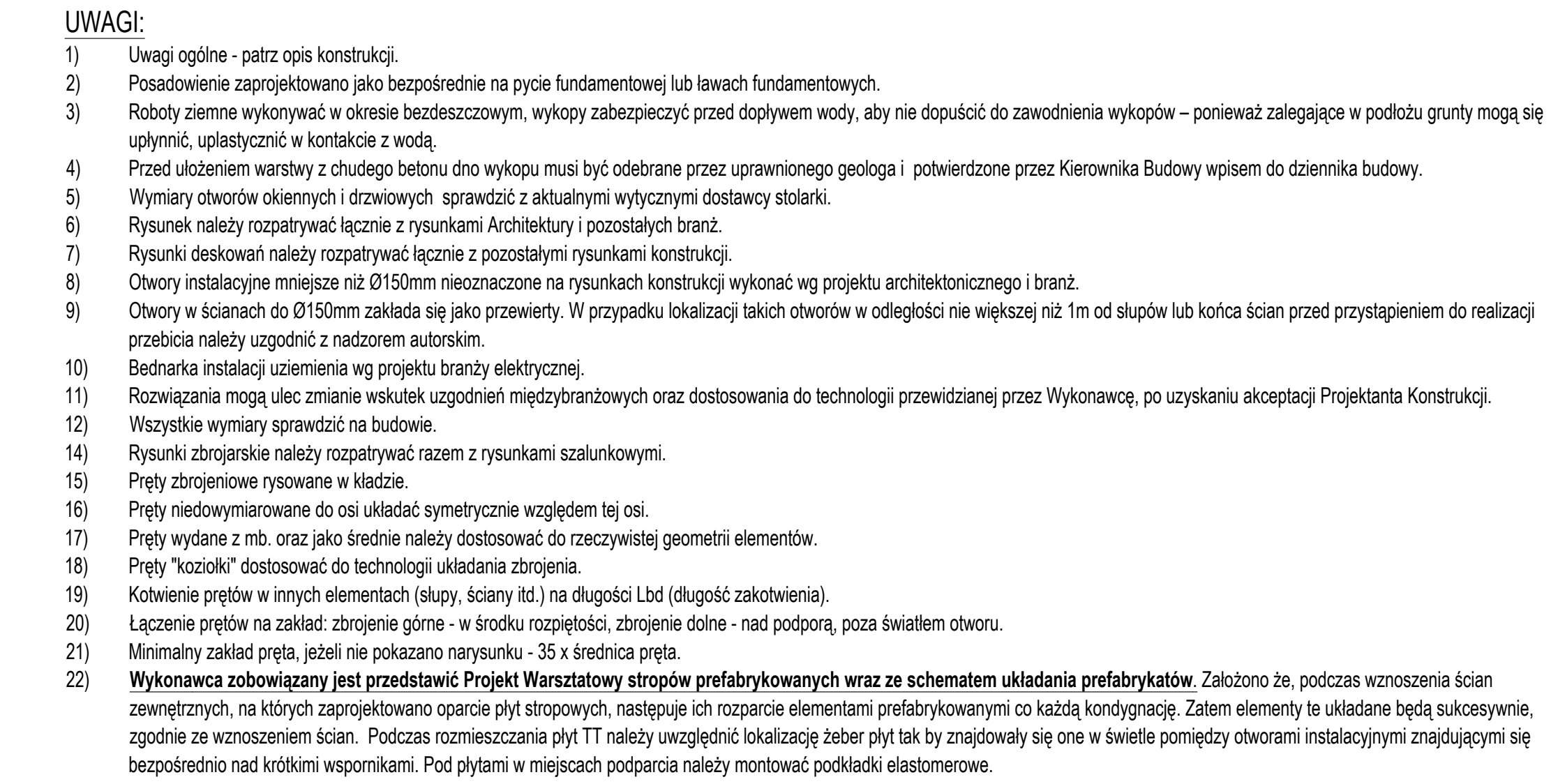
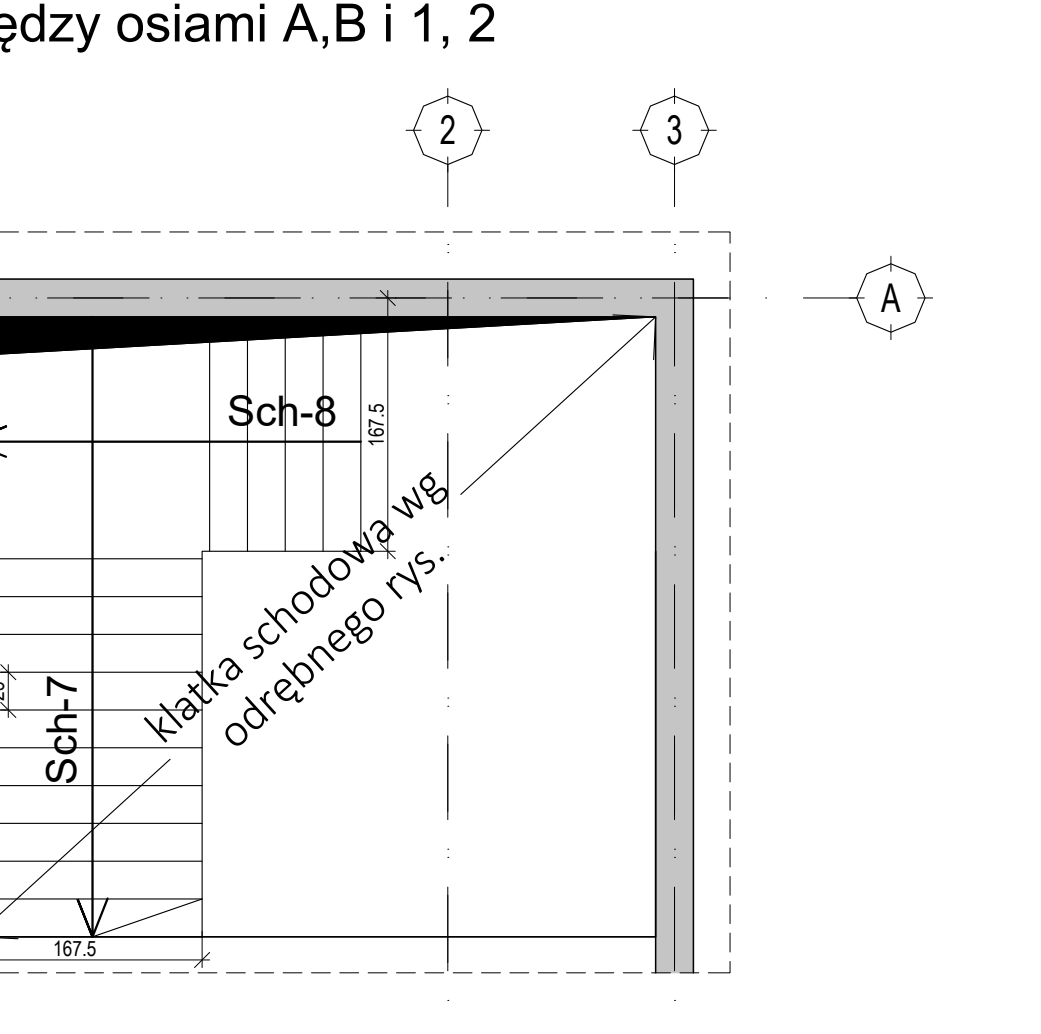
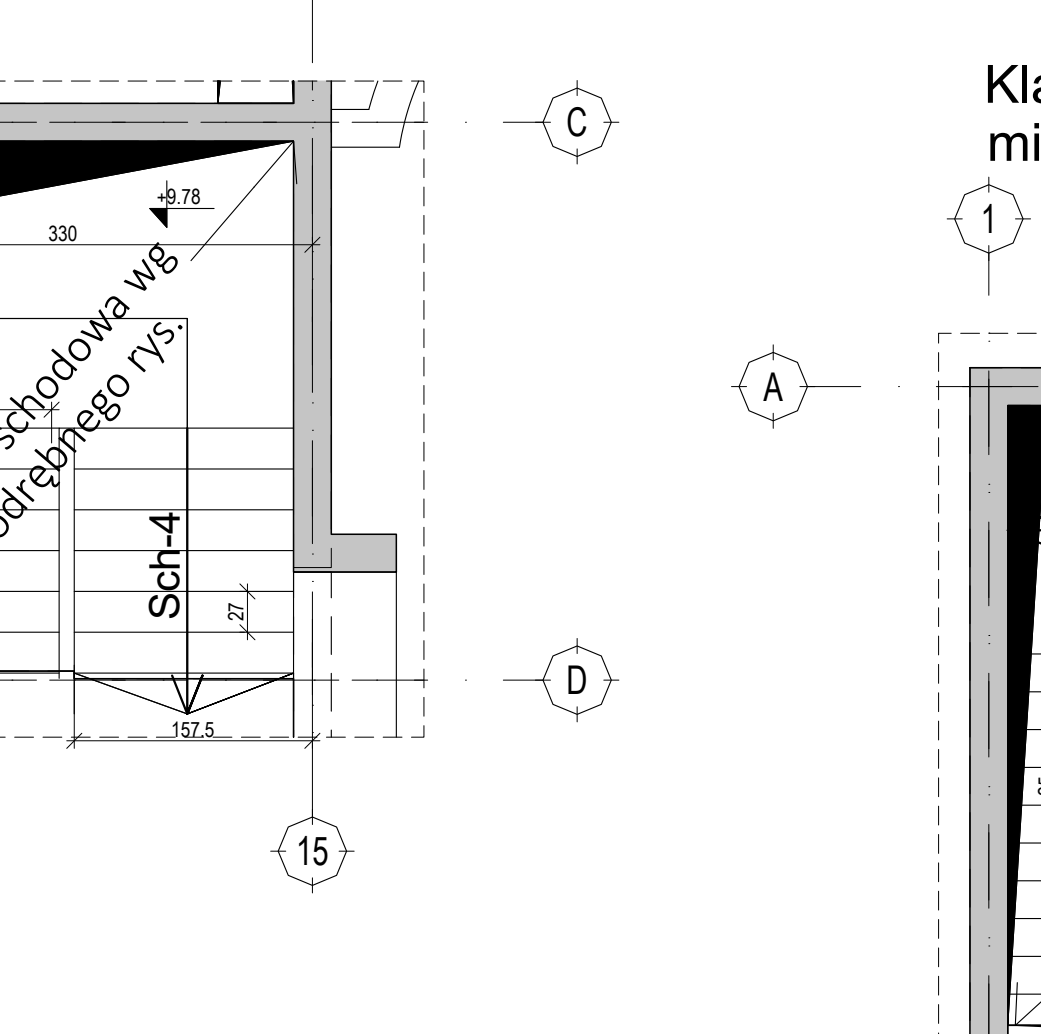
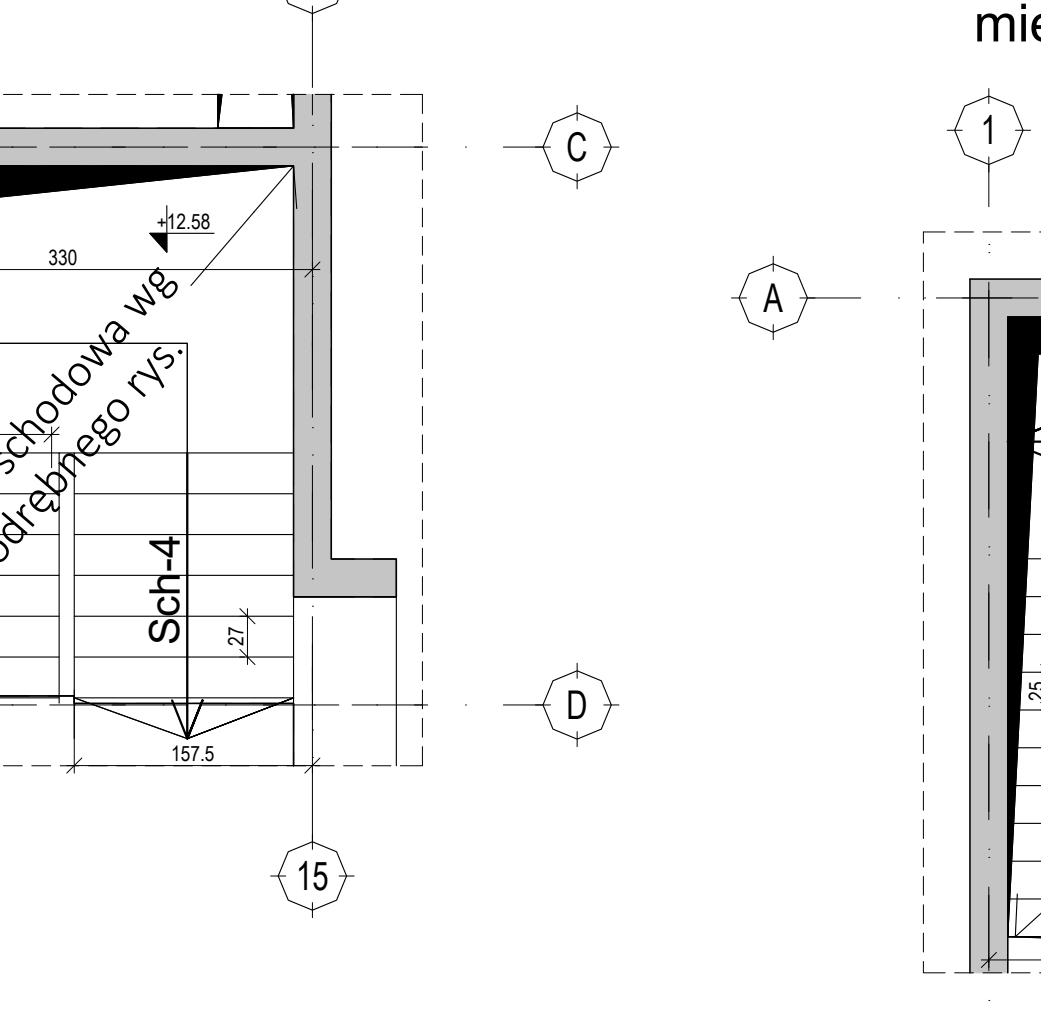
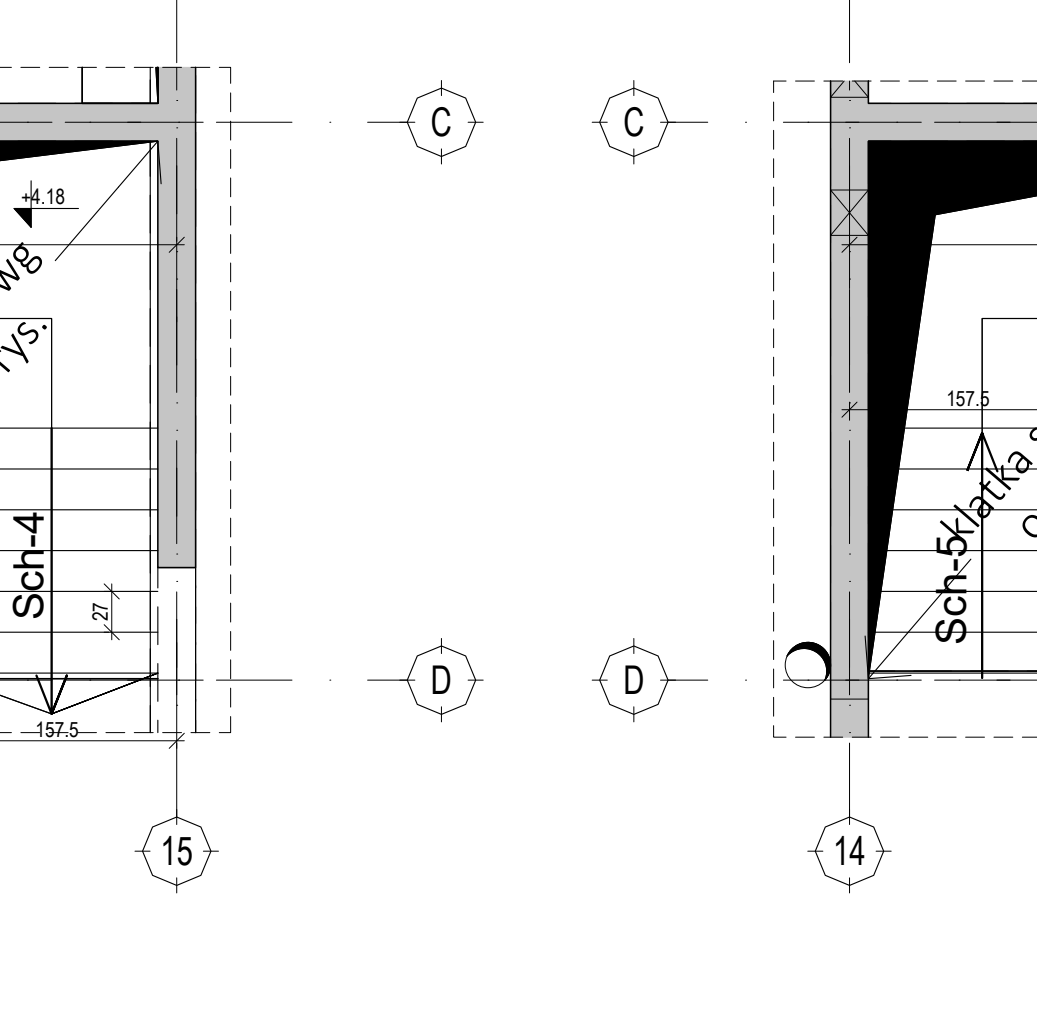
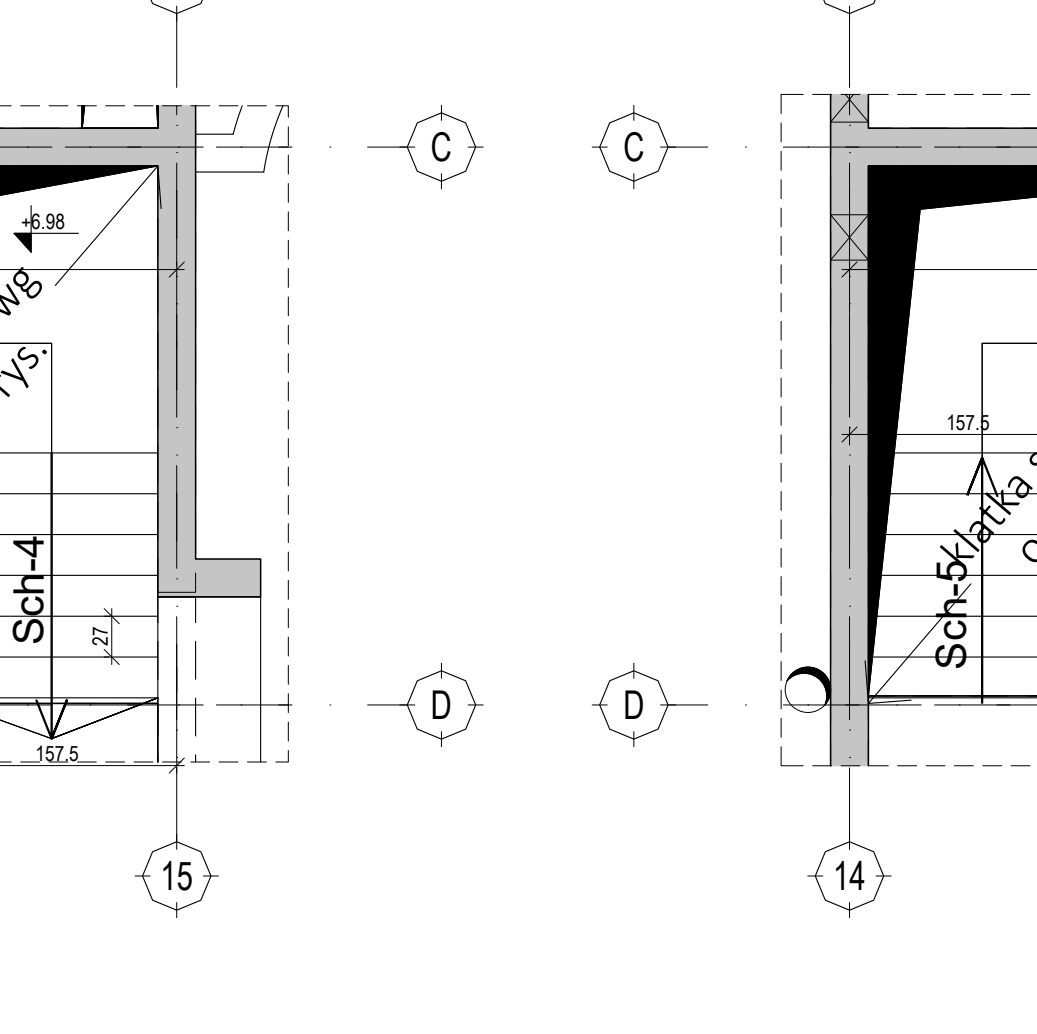
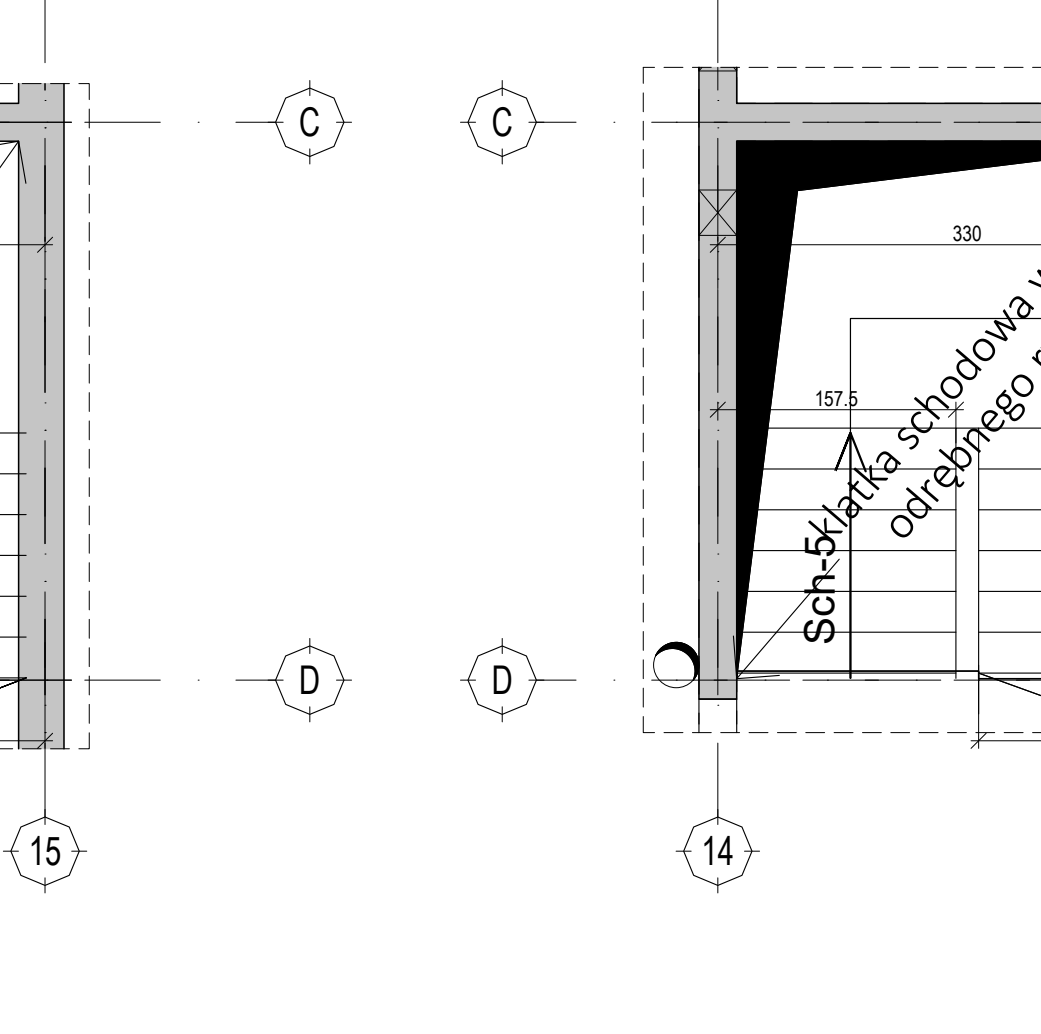
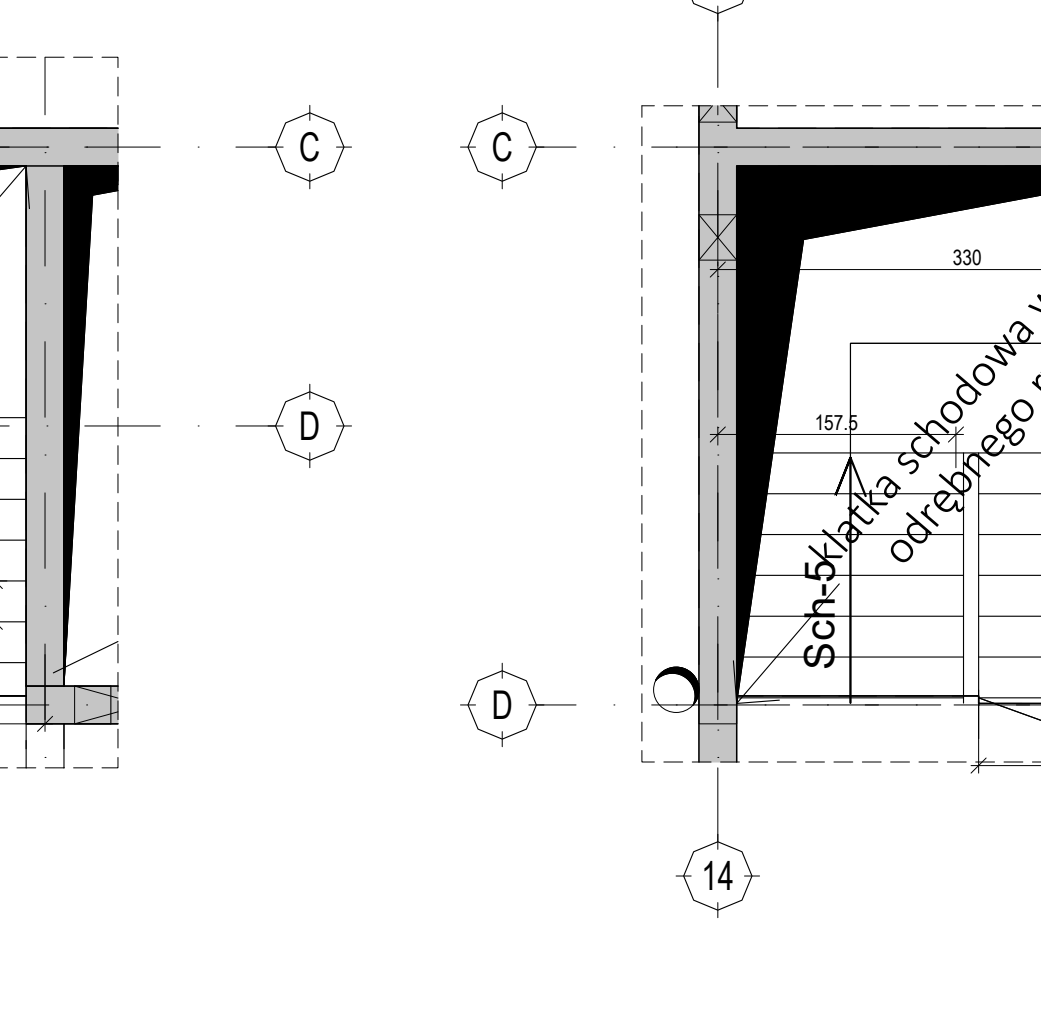
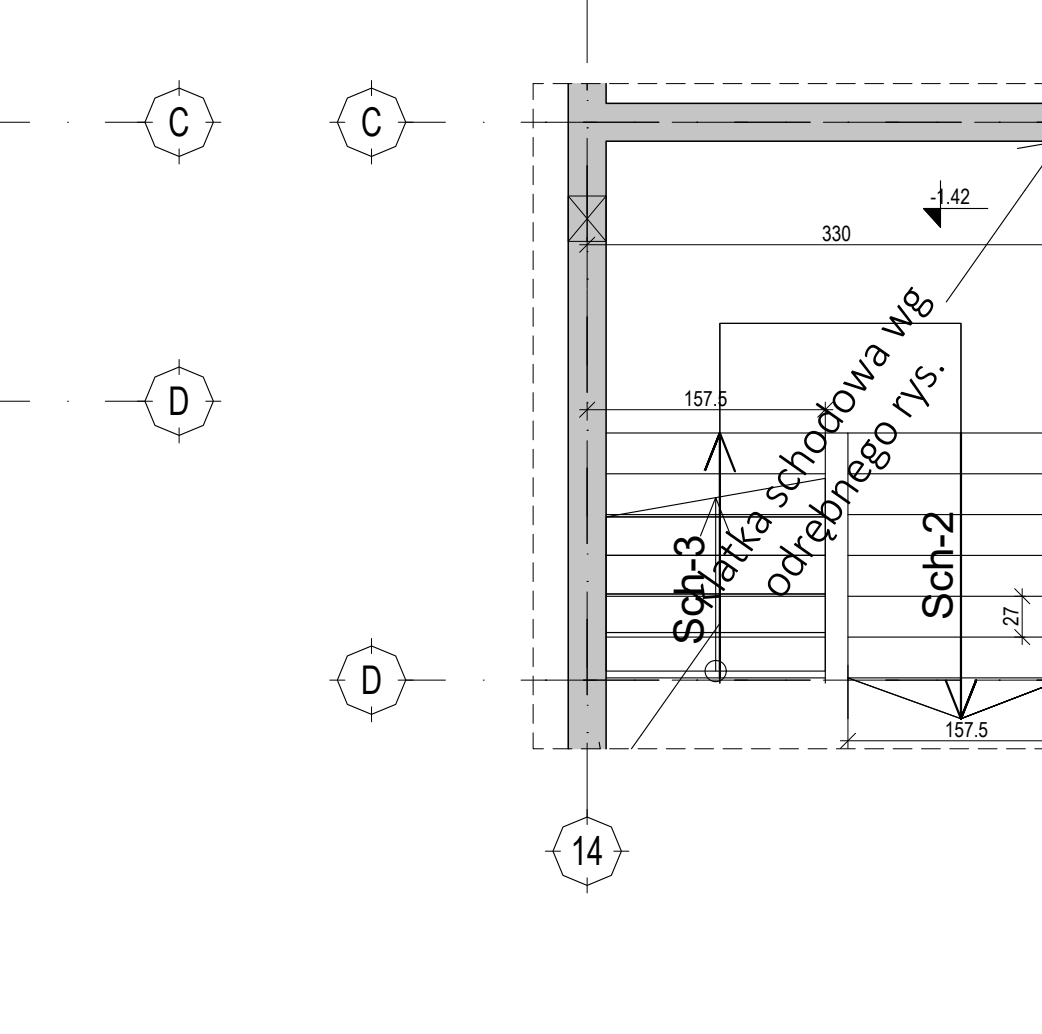
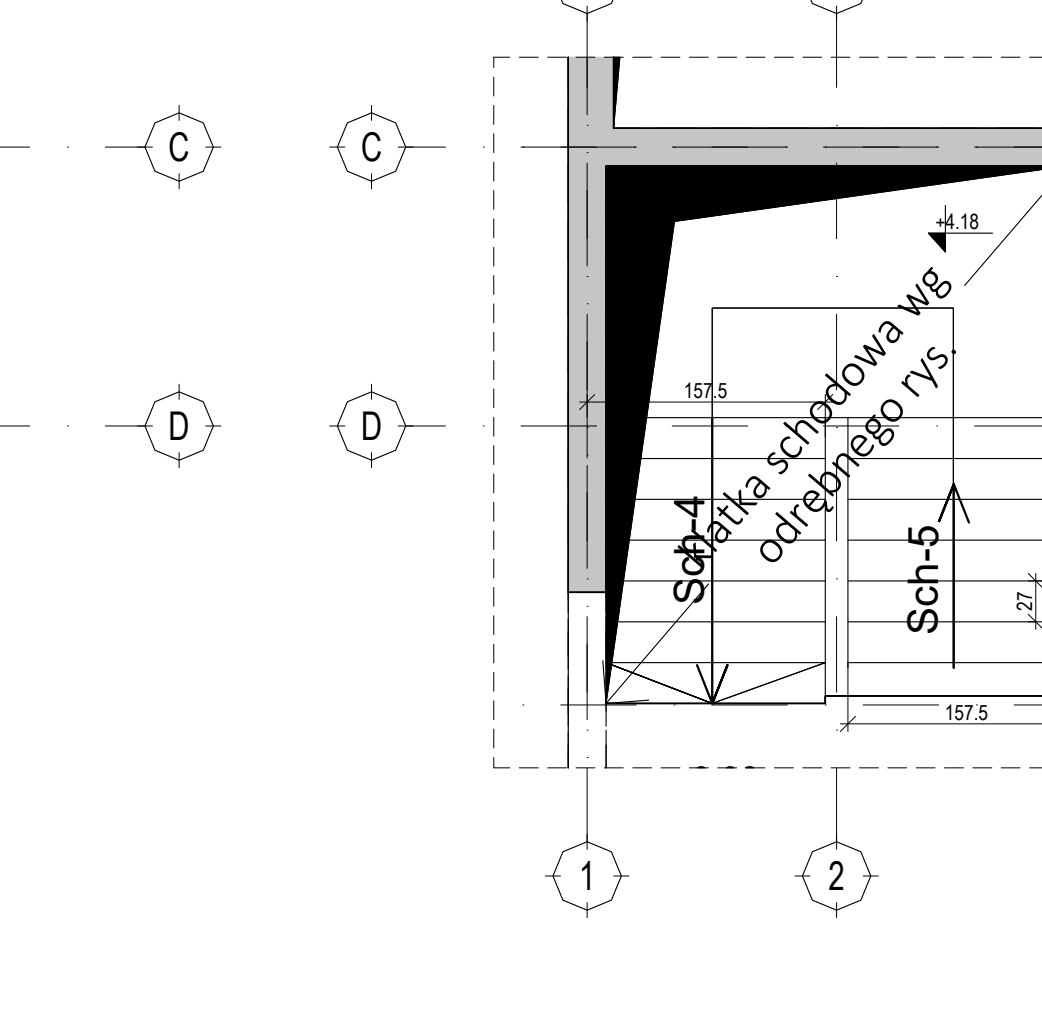
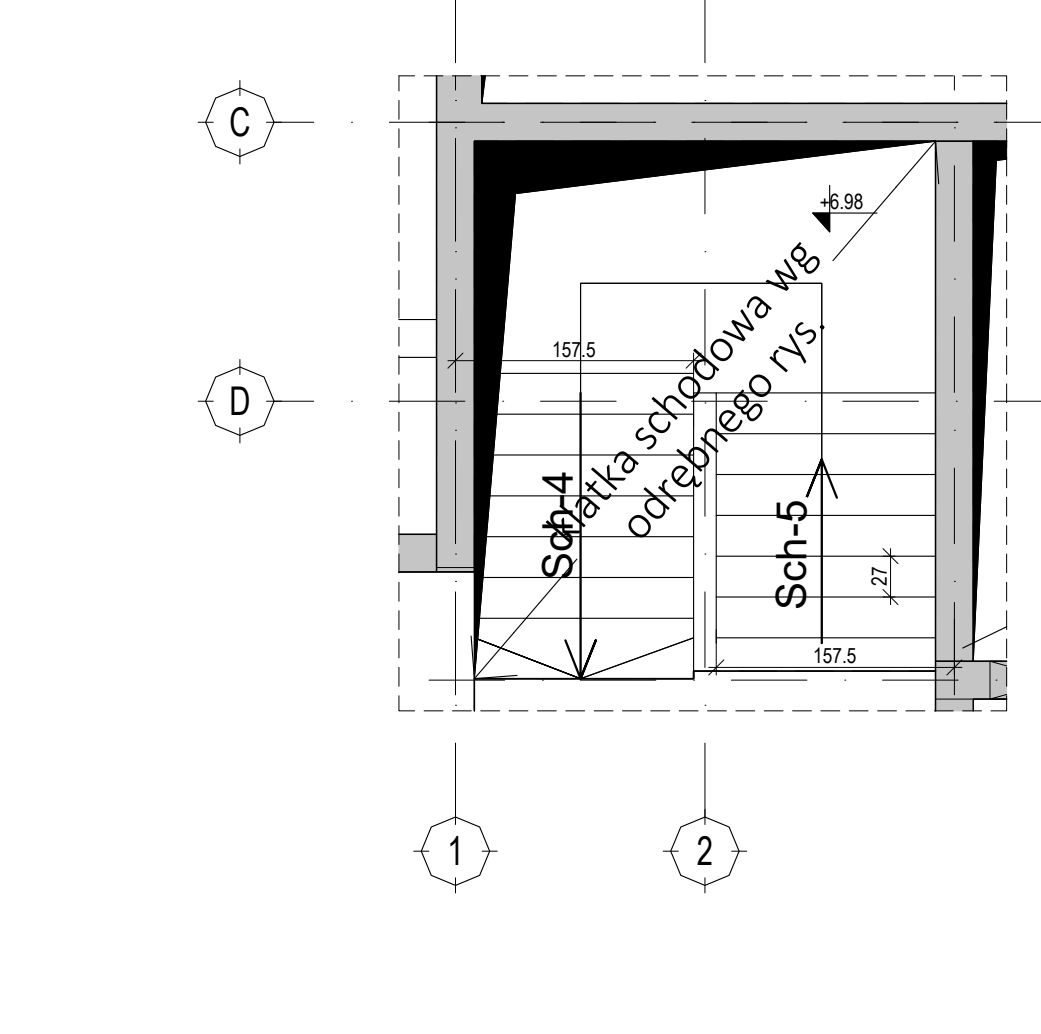
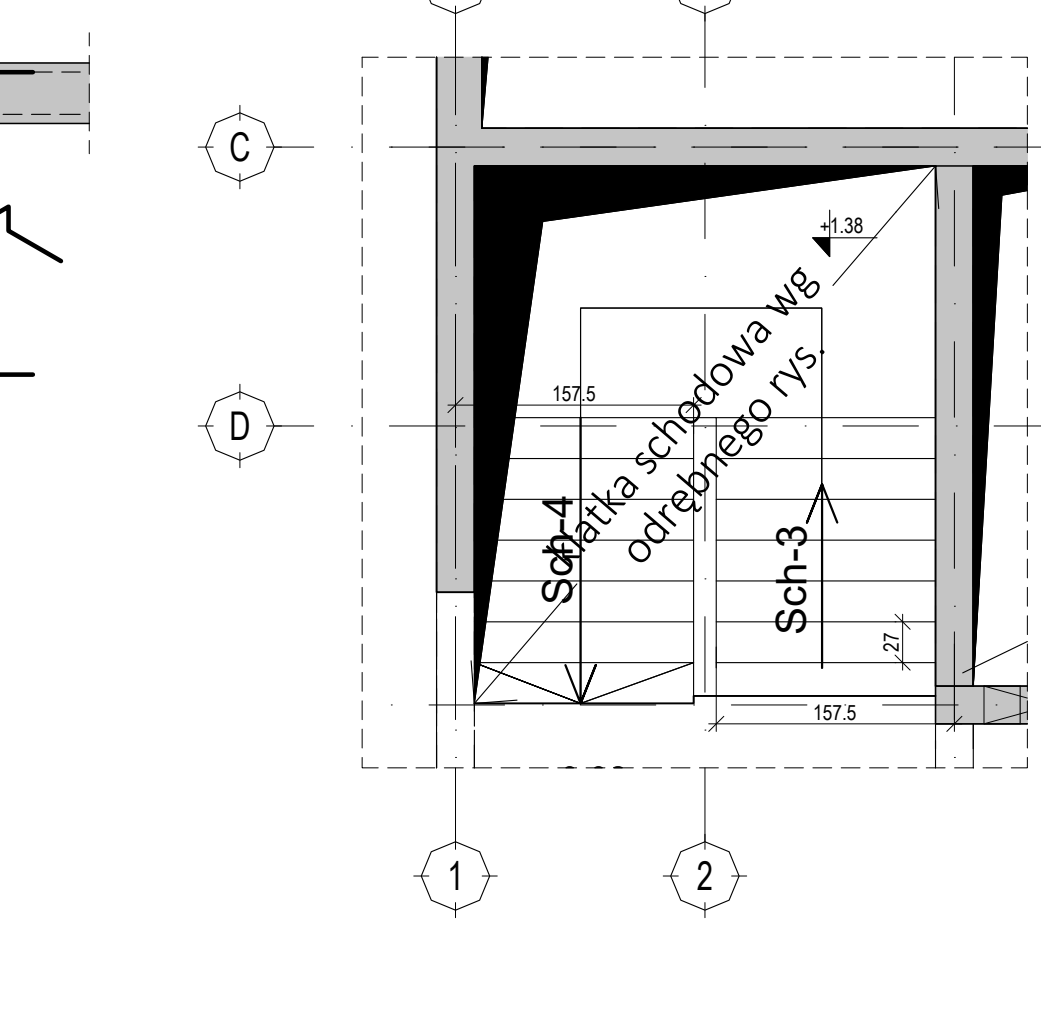
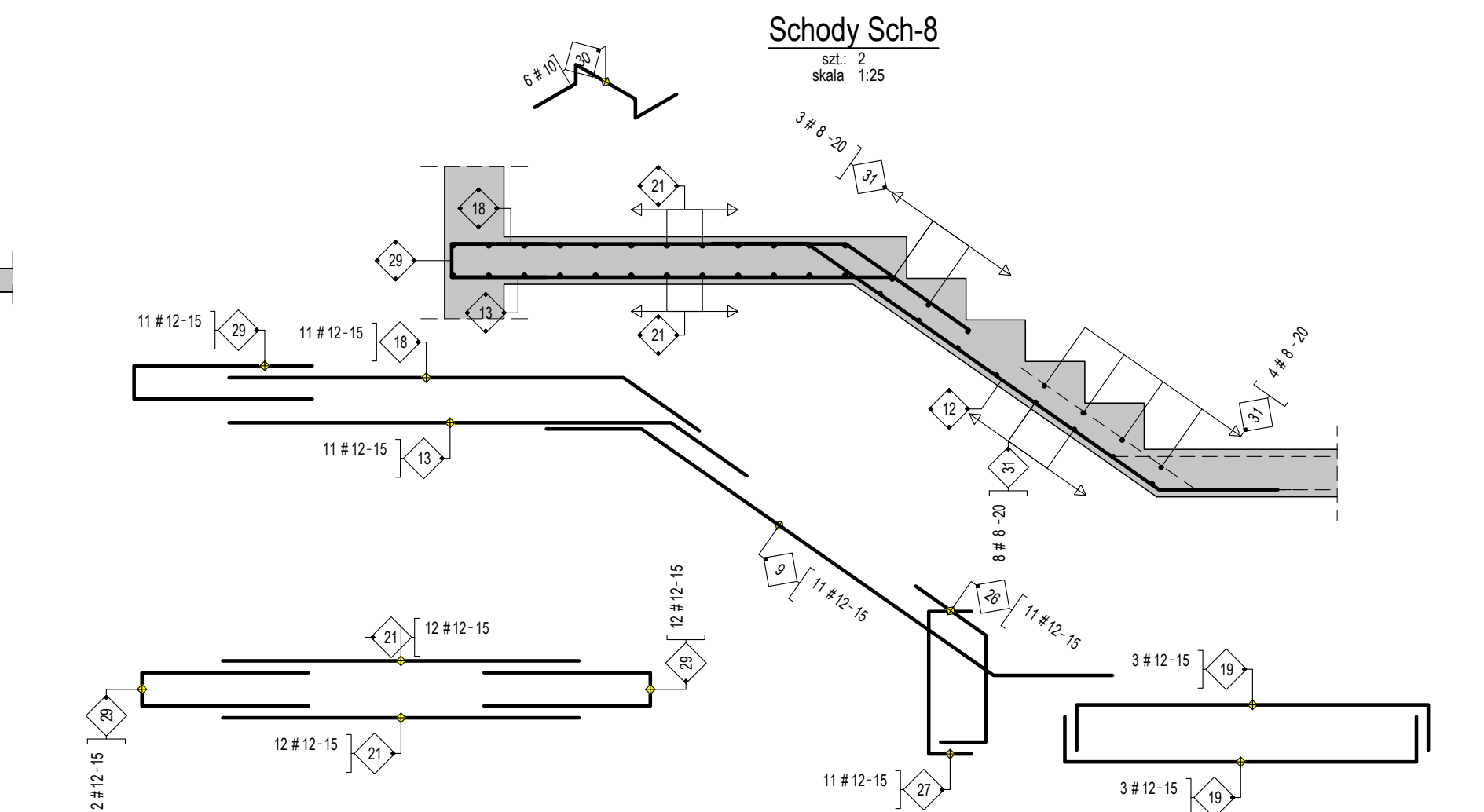
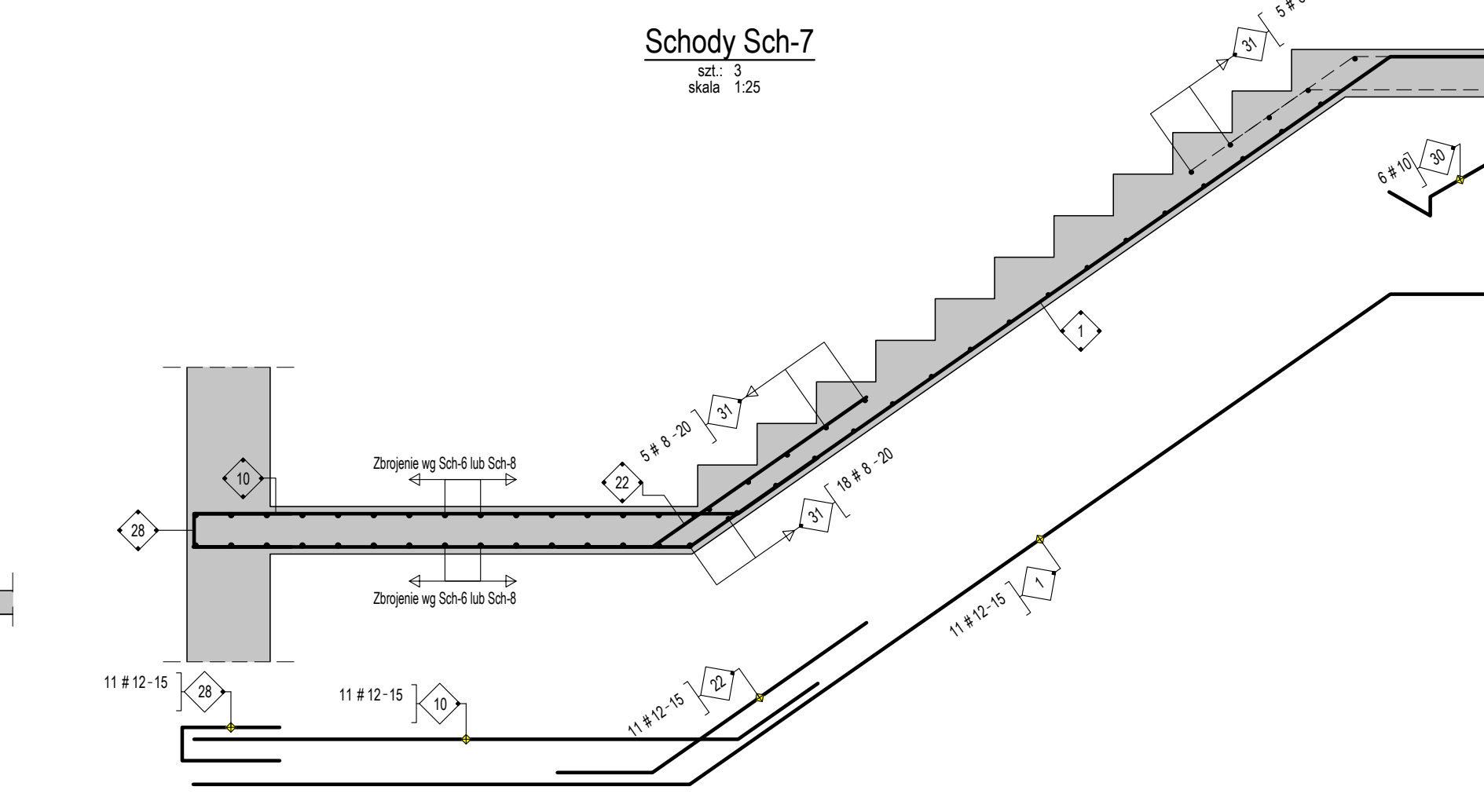
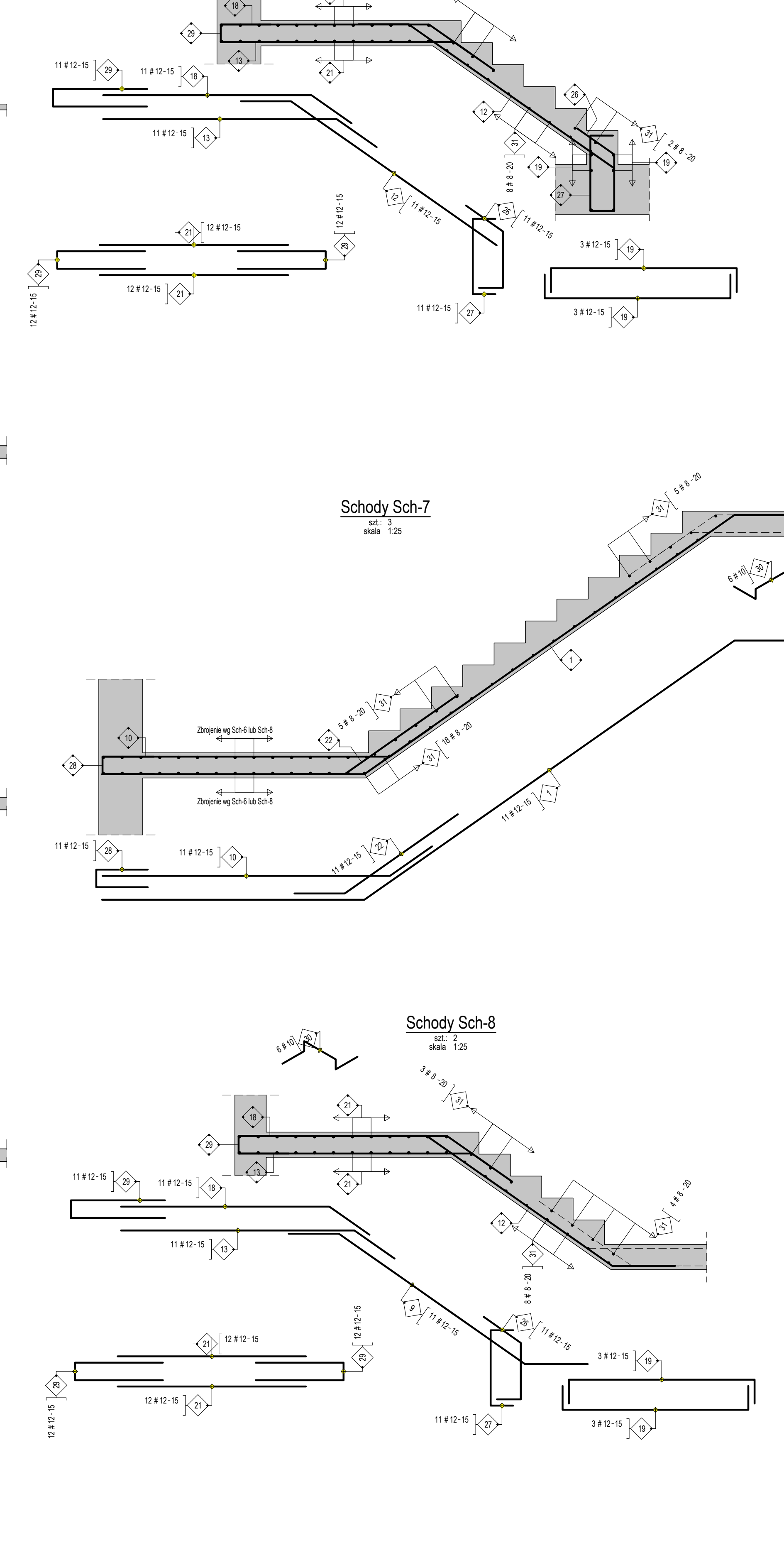
	FUNKCJA	NAZWIŚKO	NR UPRAW.	SPECJALNOŚĆ	PODPIS	Stadium: PROJEKT WYKONAWCZY
Inwestor		dyr inż. arch.				

Centralny Ośrodek Sportu w Giżycku Ul. Moniuszki 22, 11-500 Giżycko	Projektant generalny	dr inż. M. Mamecki	MPOIA/036/2009	Architektura		Treść rysunku:
		dr inż. J. Zdobych	MAP/0085/P/WOK/07	Konstrukcja		

[illegible]